

梅州市吉诚科技有限公司

TEL: 13510321033

E-mail: 295450118@qq.com

DATE:2023-12-3

SPEC. No.: $\Phi 52*11.4H$

total: 7 sheet

SPECIFICATION

SHEET FOR APPROVAL

(REVISION: 2023A Update:00)

CUSTOMER:

PRODUCTS: DYNAMIC SPEAKER

MODEL NUMBER: JC522008

CUSTOMER NUMBER:

INTERNAL DESCRIPTION:

$\Phi 52$ H11.4 8 OHM L= 端子线 防水等级;
防水泡棉:

方桂香	邓瑞瑞	张宇
ENGINEER	CHECKED	APPROVED

CUSTOMER APPROVED

SIGNATURE	IMPRINTMENT

梅州市吉诚科技有限公司

MODEL: JC522008

1. SCOPE

This specification cover our product of speaker for use in your products.

2. MECHANICAL LAYOUT & DIMENSIONS

Shown in Fig.5

3. GENERAL REQUIREMENTS

3.1 WEIGHT: Approx gram

3.2 OPERATING TEMPERATURE RANGE: -25°C to +60°C

3.3 STORAGE TEMPERATURE RANGE: -25°C to +70°C

3.4 STANDARD CONDITIONS:

Temperature:	17~25°C
Relative Humidity:	45%~80% (RH)
Air Pressure:	860~1060hPa

3.5 JUDGEMENT CONDITIONS:

Temperature:	20±2°C
Relative Humidity:	60%~70% (RH)
Air Pressure:	860~1060hPa

4. SPEAKER MODE

4.1 SOUND PRESSURE LEVEL

78±3dB SPL At800, 1000, 1200, 1500Hz in average (0dB SPL=20 μ Pa)
Input voltage: 10.0W (Sine wave) 1M Measured baffler recommended.

4.2 IMPEDANCE: 8.0±15% ohm (at 1000Hz 2.0V)

4.3 RESONANCE FREQUENCY: 2000±20%Hz at 1V. (No Baffler)

4.4 TOTAL HARMONIC DISTORTION: Less than 5% at 1KHz, 1M1W

4.5 MEASURING CIRCUIT: Shown in Fig.1.

4.6 FREQUENCY RESPONSE CURVE: Shown in Fig.2.

4.7 RATED POWER: 10.0W. **MAX POWER:** 10.5W.

4.8 PURE SOUND DETECTION: Buzz, Rattle, etc Should not be audible at 3.5V sine wave from 300 Hz to 5K Hz.

4.9 POLARITY: When a positive DC current is applied to the terminal marked (+), diaphragm shall move forward.

梅州市吉诚科技有限公司

MODEL: JC522008

■ FREQUENCY MEASURING CIRCUIT (Fig. 1)

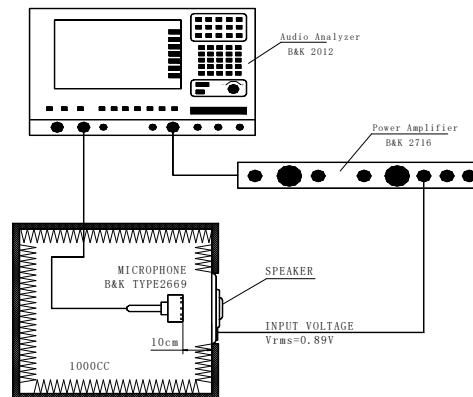

FREQUENCY RESPONSE CURVE (Fig. 2)

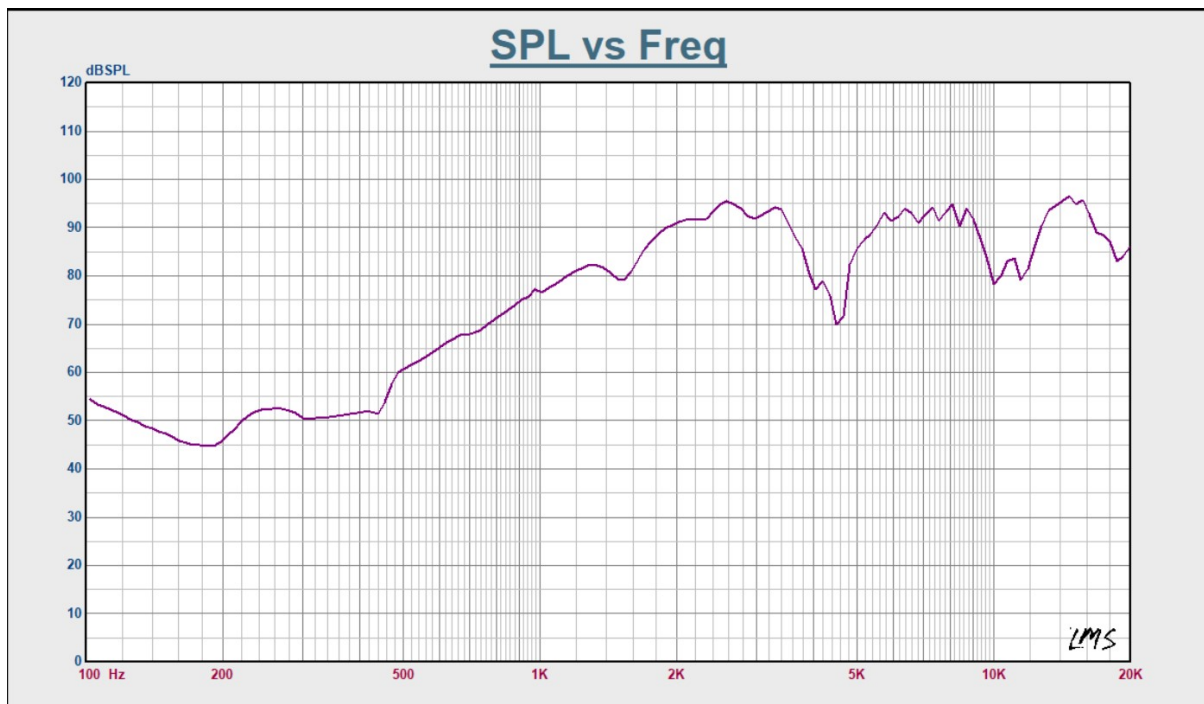

梅州市吉诚科技有限公司

MODEL: JC522008

5. RELIABILITY TESTS

① AFTER TEST

Sensitivity difference shall be within $\pm 3\text{dB}$ after test (at $800 \sim 1500\text{KHz}$ average value), pure sound detection is normal when the sample is recovered 4 hours at house temperature

② HIGH TEMPERATURE TEST

High temperature: $+55^{\circ}\text{C} \pm 2^{\circ}\text{C}$
Duration : 24 hours

③ LOW TEMPERATURE TEST

Low temperature : $-15^{\circ}\text{C} \pm 2^{\circ}\text{C}$
Duration : 24 hours

④ HUMIDITY TEST

Temperature : $+30^{\circ}\text{C} \pm 2^{\circ}\text{C}$
Relative humidity: 90~95%
Duration : 24 hours

⑤ TEMPERATURE CYCLE TEST (See in Fig.3)

Temperature : -15°C $+55^{\circ}\text{C}$
Duration : 2 hours 2 hours
Cycle : 6 cycle

⑥ VIBRATION TEST

Vibration : 10-55Hz/min
Amplitude : 1.5mm
Duration : 2 hours each axes

⑦ DROP TEST(With handset or Approved equipment) See in Fig.4

Height : 1.5 m
Cycle : 6 cycles onto the 5mm board

⑧ LOAD TEST

Subject samples to White Noise for 96 hours at 10.0W input power.

梅州市吉诚科技有限公司

MODEL: JC522008

TEMP. CYCLE TEST (Fig. 3)

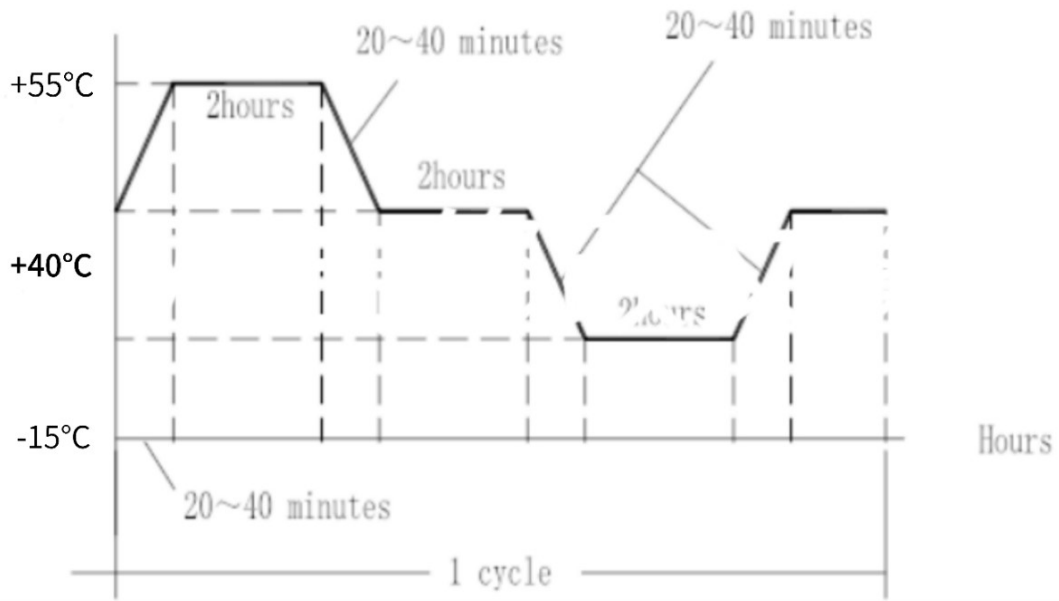

DROP TEST (Fig. 4)

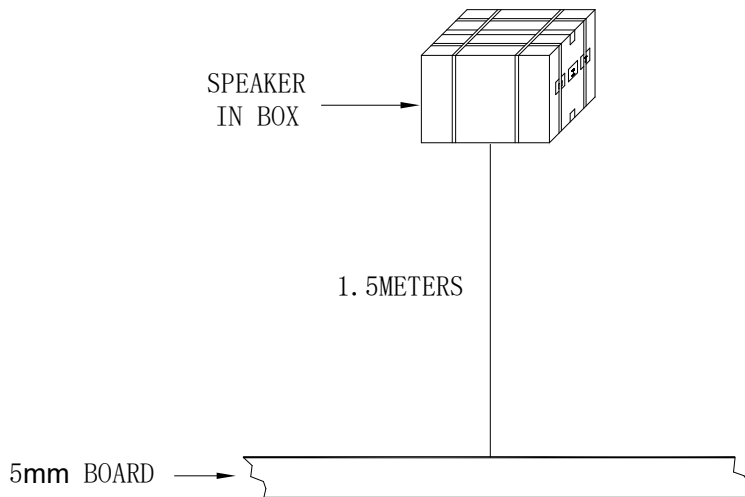

梅州市吉诚科技有限公司

MODEL: JC522008

■ TEMP. CYCLE TEST (Fig. 5)

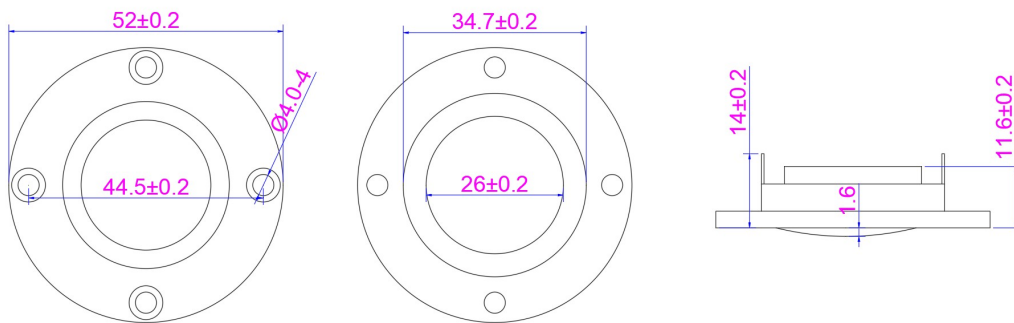

View direction:

